

# CON/KAD/003/CP

Mating connector for KAM/TCG/102, KAM/TCG/103, and KAM/TCG/105 (DD, 19-way)

**CURTISS-  
WRIGHT**

CURTISSWRIGHTDS.COM



## Key Features

- Mating connector for KAM/TCG/102, KAM/TCG/103, and KAM/TCG/105
- Includes connector shell, crimp pins, and mating screws

## Applications

- Connecting to KAM/TCG/102, KAM/TCG/103, and KAM/TCG/105

## Overview

The CON/KAD/003/CP is a 19-way double-density connector for use with the KAM/TCG/102, KAM/TCG/103, and KAM/TCG/105.

The part is supplied as a connector shell (with integral insulator), and a bag of 19 crimp pins (size 22 AWG), which may be inserted into the connector shell. The connector is electroless nickel-plated.

The mating screws are stainless steel and are held in place on the connector shell by stainless steel retaining clips.

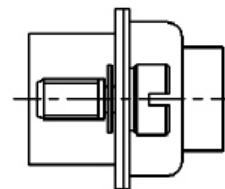
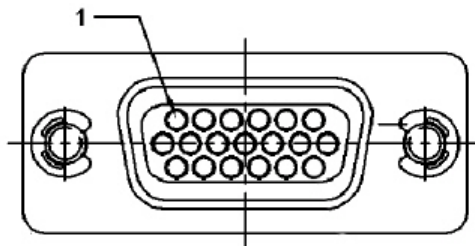
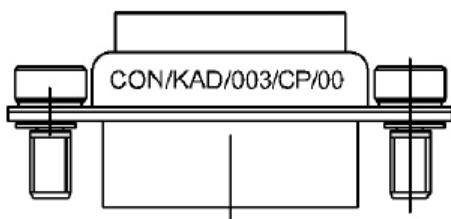

Figure 1: CON/KAD/003/CP plan, elevation and end-view

## Specifications

TABLE 1		Mechanical specifications				
PARAMETER	MIN.	TYP.	MAX.	UNITS	CONDITION/DETAILS	
Mass						
connector, screw and clip	-	8	-	g		
connector, screw and clip	-	0.3	-	oz	Design metric is grams.	
Dimensions						
connector height	-	13.7	-	mm		
connector height	-	0.5	-	in	Design metric is millimeters.	
connector length	-	31.2	-	mm		
connector length	-	1.2	-	in		
connector width	-	12.8	-	mm		
connector width	-	0.5	-	in		
screw length	-	3.5	-	mm	Length of threaded insert.	
screw length	-	0.1	-	in	Length of threaded insert.	
width of clip	-	5.0	-	mm		
width of clip	-	0.2	-	in		
Chassis clearance						
connector height	-	15.0	-	mm		
connector height	-	0.6	-	in		
bend radius height	-	35	-	mm	Without ACD/BAC/002 or ACD/BAC/003 attached.	
bend radius height	-	1.4	-	in		
Finish						
connector	-	-	-	-	Electroless nickel-plated steel.	
screw	-	-	-	-	Stainless steel.	
clip	-	-	-	-	Stainless steel.	
integral isolator housing	-	-	-	-	Nylon.	
pins	-	-	-	-	Copper alloy with 1.2 $\mu$ m gold plating. Crimp pins accommodate cable size 22 - 26 AWG.	
pins and retaining clips	-	-	-	-	Stainless steel.	

## Getting the most from the CON/KAD/003/CP

This 19-way double-density mating connector is used with the KAM/TCG/102, KAM/TCG/103, and KAM/TCG/105. The CON/KAD/003/CP is supplied with 19 loose pin contacts. See the Getting the most from section of the *KIT/001* data sheet for instructions on how to insert these pins.

When mating and un-mating double-density connectors, jackscrews should be screwed/unscrewed by half a turn alternately on each side until the connectors are fully mated/un-mated. Failure to mate/un-mate the connectors in this manner may result in deformation of the module top connector, which can reduce the reliability of the electrical contact of the connector/module with the contact face.

---

**WARNING:** It is recommended that pins are only inserted once into each pin location of the connector. A reinsertion of any pin into a location where a pin has been removed may result in a loose pin.

## Ordering information

PART NUMBER	DESCRIPTION
CON/KAD/003/CP	Mating connector for KAM/TCG/102, KAM/TCG/103, and KAM/TCG/105 (DD, 19-way)

## Revision history

REVISION	DIFFERENCES	STATUS
CON/KAD/003/CP	Issued first release of data sheet.	Recommended for new programs

## Related products

MODULE	DETAILS
ACD/BAC/004	Backshell for CON/KAD/003/CP

## Related documentation

DOCUMENT	DETAILS
DOC/DBK/001	Acra KAM-500 Databook
DOC/MAN/018	KSM-500 Databook
DOC/HBK/002	Environmental Qualification Handbook